



COVID-19 SAFETY PLAN ACADEMIC SPACES

RATIONALE FOR ON-CAMPUS ACTIVITY

Please provide a short description explaining the need for students to be on campus. Your narrative should be focused on the practical elements of the program or activity that are critical to achieving learning outcomes, and why on campus components cannot be replicated in an online or alternative environment (e.g. student bringing learning equipment home).

This is a night school hands on milling course that started before March 2020; halfway through the course the campus closed down. The students have not returned to campus to complete the course. To complete the course 7 students need to return to campus for 5 more hands on classes, Tuesday and Thursday nights from 7 to 10 pm.

This safety plan has been developed from RTC 16 and RTC 18 which covered full-time student activities in NW06 100.

CONTROL MEASURES

COVID-19 SAFETY PLAN: CONTROL MEASURES CHECKLIST

Directions for completing a Safety Plan:

1. First step of this process is to review the [BCIT COVID-19 Go-Forward Plan](#) as the overall planning document for this process.
2. Use this checklist as a tool to assess COVID-19 control measure preparedness for students and employees and the spaces they will be using. Refer to the [BCIT COVID-19 Go-Forward Plan](#) for standardized safety guidelines and procedures.
3. For each control measure, state the details. If the control measure is a 'No' or 'NA', please provide a brief explanation.
4. The manager requests all PPE requirements by submitting this draft Safety Plan to the PPE@bcit.ca.
5. Implement all the safety measures in this Safety Plan.
6. The manager completes a site visit to ensure all control measures and safety supplies are in place.
7. The manager signs the completed Safety Plan and submits it to returntocampus@bcit.ca for approval.
8. Once approved, the COVID-19 Safety Plan is posted in all work areas identified within this plan.

Note: The workspaces cannot be used until all applicable control measures are in place and Safety Plan is approved. For additional resources the [Risk Assessment Controls Guidance and Hierarchy of Controls](#). For assistance email ssemohs@bcit.ca.

COVID-19 SAFETY PLAN ACADEMIC SPACES

#	Control Measure	Yes	No	NA	Details (as per Directions)
ELIMINATION					
1.	Room(s) set up to allow for 2 metres physical distancing during instruction and practice. Note: Contact returntocampus@bcit.ca for room capacity and layout if needed.	<input checked="" type="checkbox"/>	<input type="checkbox"/>	<input type="checkbox"/>	Exceptions allowed as per BCIT COVID-19 Go-Forward Plan , Risk Matrix Summary (explain): Machine shop is a large area and social distancing can be maintained.
2.	Demonstration, work and assessment stations are set-up to allow for 2 metres physical distancing.	<input checked="" type="checkbox"/>	<input type="checkbox"/>	<input type="checkbox"/>	Exception allowed as per BCIT COVID-19 Go-Forward Plan , Risk Matrix Summary (explain): Each student is assigned a separate machine tool with 2 metre distancing maintained.
3.	Identified area(s) where students wait outside of teaching space until allowed inside by instructor.	<input checked="" type="checkbox"/>	<input type="checkbox"/>	<input type="checkbox"/>	When students arrive, they will wait in the bench area which provide 2 metre spacing.
4.	Work has been scheduled to minimize numbers of individuals on campus at one time.	<input checked="" type="checkbox"/>	<input type="checkbox"/>	<input type="checkbox"/>	PTS class – only 7 students attending
5.	In shared spaces, safety protocols have been put in place to reduce close contact between users.	<input checked="" type="checkbox"/>	<input type="checkbox"/>	<input type="checkbox"/>	Masks to be worn if 2m is not maintained such as when providing individual instruction on a machine tool
6.	Movement within the room is identified, such as with directional arrows, for walkways and entrances/exits.	<input checked="" type="checkbox"/>	<input type="checkbox"/>	<input type="checkbox"/>	Signs or arrows on the floor identifying directions.
7.	Water fountains are put out of service, and only touchless water bottle filling station available.	<input checked="" type="checkbox"/>	<input type="checkbox"/>	<input type="checkbox"/>	
8.	Mobile fans have been removed or put out of service.	<input checked="" type="checkbox"/>	<input type="checkbox"/>	<input type="checkbox"/>	
7.	Washrooms have been identified.	<input checked="" type="checkbox"/>	<input type="checkbox"/>	<input type="checkbox"/>	If yes, Washroom occupancy limit <u> 2 </u>
8.	Break area(s) for student use have been identified.	<input type="checkbox"/>	<input type="checkbox"/>	<input checked="" type="checkbox"/>	If yes, what control measures are in place to maintain physical distancing? Occupancy Limit _____ If there is an occupancy limit, is sign posted? Y Night school - no breaks required <input type="checkbox"/> N <input type="checkbox"/>
9.	Break areas for employee use have been identified.	<input type="checkbox"/>	<input type="checkbox"/>	<input checked="" type="checkbox"/>	If yes, what control measures are in place to maintain physical distancing? Night school no breaks required; instructor has access to office area if required Occupancy Limit <u> 4 </u> If there is an occupancy limit, is sign posted? Y <input checked="" type="checkbox"/> N <input type="checkbox"/>
10.	Other:	<input type="checkbox"/>	<input type="checkbox"/>	<input checked="" type="checkbox"/>	
ENGINEERING CONTROL MEASURES					
11.	Barriers are implemented to separate work areas or walk ways, when physical distancing not practical.	<input checked="" type="checkbox"/>	<input type="checkbox"/>	<input type="checkbox"/>	Barriers have been constructed to support fulltime instruction; no changes required.
12.	Barriers are stable and do not introduce other safety hazards, e.g. tripping.	<input checked="" type="checkbox"/>	<input type="checkbox"/>	<input type="checkbox"/>	Existing barriers have demonstrated stability and no safety hazards.

COVID-19 SAFETY PLAN ACADEMIC SPACES

#	Control Measure	Yes	No	NA	Details (as per Directions)
13.	The impact on ventilation requirements have been considered if there's been a significant use change for the instructional space.	<input type="checkbox"/>	<input type="checkbox"/>	<input checked="" type="checkbox"/>	Complete a Facilities and Campus Development work requisition for assessment, as needed.
	Other:	<input type="checkbox"/>	<input type="checkbox"/>	<input checked="" type="checkbox"/>	
SIGNAGE (ADMINISTRATIVE) Signage is available @ BCIT online Inventory . Guidelines for posting signs are available on ShareSpace .					
13.	Posted: Physical distancing (2 m) sign(s) Item 1A	<input checked="" type="checkbox"/>	<input type="checkbox"/>	<input type="checkbox"/>	
14.	Posted: Hand washing sign(s) Item 29B	<input checked="" type="checkbox"/>	<input type="checkbox"/>	<input type="checkbox"/>	
15.	Posted: Health screen sign(s) Item 3C	<input checked="" type="checkbox"/>	<input type="checkbox"/>	<input type="checkbox"/>	
16.	Posted: Hand washing sink location sign(s) Item 14A	<input checked="" type="checkbox"/>	<input type="checkbox"/>	<input type="checkbox"/>	
17.	Posted: Hand sanitizing station location sign(s) Item 13A	<input checked="" type="checkbox"/>	<input type="checkbox"/>	<input type="checkbox"/>	
18.	Posted: Protect yourself sign(s) Item 21A	<input checked="" type="checkbox"/>	<input type="checkbox"/>	<input type="checkbox"/>	
19.	Posted: Occupancy limit of this room sign(s) Item 37A	<input checked="" type="checkbox"/>	<input type="checkbox"/>	<input type="checkbox"/>	
20.	Posted: Other signs	<input type="checkbox"/>	<input type="checkbox"/>	<input checked="" type="checkbox"/>	Please list:
ORIENTATION AND TRAINING (ADMINISTRATIVE)					
21.	Routine safety discussions held to review control measures and safety protocols.	<input checked="" type="checkbox"/>	<input type="checkbox"/>	<input type="checkbox"/>	
22.	All students have completed the online COVID-19 Pandemic On-Campus Guidelines training.	<input checked="" type="checkbox"/>	<input type="checkbox"/>	<input type="checkbox"/>	How will compliance be checked: Department will run a report prior to class start.
23.	COVID-19 safety Site orientation for students has been developed and posted in the Learning Hub.	<input checked="" type="checkbox"/>	<input type="checkbox"/>	<input type="checkbox"/>	Procedure for orientation found here . Student COVID-19 Orientation Checklist found here .
24.	All employees have completed the online BCIT Pandemic Exposure Control Plan Training .	<input checked="" type="checkbox"/>	<input type="checkbox"/>	<input type="checkbox"/>	Faculty and toolroom attendant have completed training as part of their fulltime return to campus activities.
25.	All employees have completed the online OHS New Employee Orientation module .	<input checked="" type="checkbox"/>	<input type="checkbox"/>	<input type="checkbox"/>	New and Returning Employee Orientation Checklist found here . Each employee to save the checklist to their online OHS New Employee Orientation course. This course is required to be completed by new employees and by employees working on campus.
26.	Other:	<input type="checkbox"/>	<input type="checkbox"/>	<input checked="" type="checkbox"/>	
RULES AND GUIDELINES (ADMINISTRATIVE)					
27.	All unnecessary and self-serve items have been removed from the spaces. e.g., pens, paper, etc.	<input checked="" type="checkbox"/>	<input type="checkbox"/>	<input type="checkbox"/>	All supplies asked for prior to class and stocked at each workspace

COVID-19 SAFETY PLAN ACADEMIC SPACES

#	Control Measure	Yes	No	NA	Details (as per Directions)
28.	Doors that students are to use to enter and exit have been clearly identified.	<input checked="" type="checkbox"/>	<input type="checkbox"/>	<input type="checkbox"/>	<i>Signs or arrows on the floor</i>
29.	Handouts, papers, and items are not physically provided to students.	<input checked="" type="checkbox"/>	<input type="checkbox"/>	<input type="checkbox"/>	<i>If items are provided, they are cleaned between student use or disposed, or other control measures are in place – Describe: Any paper to be distributed will be to individual assigned space.</i>
30.	Students have dedicated tools/equipment, e.g., items are not shared between students.	<input checked="" type="checkbox"/>	<input type="checkbox"/>	<input type="checkbox"/>	Toolroom has processes in place to assign tools to individual students.
31.	If cleaning common touch points or tools/equipment not practical, then it is identified when hands are washed/sanitized before and after use.	<input checked="" type="checkbox"/>	<input type="checkbox"/>	<input type="checkbox"/>	<i>Explain: Protocols in place to ensure common touch points are cleaned.</i>
32.	Work spaces/stations are dedicated for an individual or group use and not shared with others.	<input checked="" type="checkbox"/>	<input type="checkbox"/>	<input type="checkbox"/>	Individuals are assigned a machine tool.
33.	Single-use (disposable) products are used where feasible.	<input checked="" type="checkbox"/>	<input type="checkbox"/>	<input type="checkbox"/>	
34.	Measures are in place to accommodate student sick at home.	<input checked="" type="checkbox"/>	<input type="checkbox"/>	<input type="checkbox"/>	<i>Accommodation plan:</i>
35.	Procedures in place to screen students on a daily basis.	<input checked="" type="checkbox"/>	<input type="checkbox"/>	<input type="checkbox"/>	<i>The health screen poster is available for reference and is posted on building doors. Students and employees are expected to self assess daily, and the BCCDC self-assessment tool can be used to support this.</i>
36.	There is a procedure in place if a student or employee becomes ill on campus.	<input checked="" type="checkbox"/>	<input type="checkbox"/>	<input type="checkbox"/>	<i>Refer to the COVID-19 Pandemic Scenario Response Plan for more information. If the person is reporting symptoms, ask them to avoid others and return home. If they require immediate medical attention, call First Aid and 911.</i>
37.	There are procedures in place if a student or employee travels before coming to campus, or has been in close contact with someone who has tested positive for COVID-19.	<input checked="" type="checkbox"/>	<input type="checkbox"/>	<input type="checkbox"/>	<i>Refer to the COVID-19 Pandemic Scenario Response Plan for more information. Confirm if the person is aware of self-isolation requirements and protocols.</i>
38.	Provisions made for students to maintain same lab/class cohort throughout the Term.	<input checked="" type="checkbox"/>	<input type="checkbox"/>	<input type="checkbox"/>	
39.	Other:	<input type="checkbox"/>	<input type="checkbox"/>	<input checked="" type="checkbox"/>	
PERSONAL PROTECTIVE EQUIPMENT (PPE). Refer to the PPE Flowchart to determine what PPE is required for COVID-19 purposes.					
40.	Appropriate PPE for the hazards of employee and student tasks are available to be provided (non-COVID-19 related ppe).	<input checked="" type="checkbox"/>	<input type="checkbox"/>	<input type="checkbox"/>	<i>List the ppe and tasks/activities it is required for, and provide the quantity and unit of measure, if applicable (e.g. 2 boxes of 20 each box): Eye protection, safety boots, coveralls appropriate for machining are supplied by student – identified as a course requirement</i>
41.	Training is provided for the above PPE to students and employees.	<input checked="" type="checkbox"/>	<input type="checkbox"/>	<input type="checkbox"/>	Safety orientation provided at start of course; additional session added to course to review as well as orient students to COVID 19 protocols

COVID-19 SAFETY PLAN ACADEMIC SPACES

#	Control Measure	Yes	No	NA	Details (as per Directions)
42.	Appropriate PPE for COVID-19 is available to be provided to students and employees. Supply requests emailed to ppe@bcit.ca .	<input checked="" type="checkbox"/>	<input type="checkbox"/>	<input type="checkbox"/>	Based on circumstances allowed for in the BCIT COVID-19 Go-Forward Plan , Risk Assessment Matrix Summary. List PPE and tasks/activities required for and provide the quantity and unit of measure, if applicable (e.g. 2 boxes of 20 each box): Estimated 40 disposable masks and gloves
43.	PPE safe donning, doffing, disposal, and disinfecting instructional materials are available for students and employees.	<input checked="" type="checkbox"/>	<input type="checkbox"/>	<input type="checkbox"/>	Post applicable signs in a visible location if ppe required. Use the Student Orientation checklist to assist orientation/training by instructors. Use the OHS Employee Orientation checklist to assist orientation/training by their supervisors.
44.	Other:	<input type="checkbox"/>	<input type="checkbox"/>	<input checked="" type="checkbox"/>	
CLEANING					
45.	Facilities is aware of the cleaning needs for the area. Facilities work requests have been submitted.	<input type="checkbox"/>	<input type="checkbox"/>	<input checked="" type="checkbox"/>	Cleaning includes common touch points and appropriate frequency for the area. This includes high touch areas. Provide FCD work request number(s). Students clean their work areas.
46.	Training will be provided to faculty and students performing cleaning duties and cleaning materials have been provided.	<input checked="" type="checkbox"/>	<input type="checkbox"/>	<input type="checkbox"/>	Cleaning Standard Operating Procedures have been located here . What are the cleaning products/materials: EP66 – individual cleaning bottles provided What ppe is required: Nitrile gloves, eye protection
47.	Assessment of sufficient number of hand wash stations conducted, and an appropriate number of handwashing stations are available	<input checked="" type="checkbox"/>	<input type="checkbox"/>	<input type="checkbox"/>	Consider time it will take for hand washing to take place, to determine what is e.a. sufficient number of hand wash stations. Some areas find a ratio of 8:1, students to sink, effective. The minimum amount of hand washing required is once before class starts, after class ends and before and after breaks.
48.	Handwashing station(s), stocked, easily accessed, and have been identified to students and employees.	<input checked="" type="checkbox"/>	<input type="checkbox"/>	<input type="checkbox"/>	Sink Location: <u>NW06 108</u> Stocked with soap Y <input checked="" type="checkbox"/> N <input type="checkbox"/> paper towel Y <input checked="" type="checkbox"/> N <input type="checkbox"/>
49.	Hand sanitizing station(s), stocked, and have been identified to students and employees.	<input checked="" type="checkbox"/>	<input type="checkbox"/>	<input type="checkbox"/>	ABHS (Alcohol-Based Hand Sanitizer): Location(s) <u>multiple</u> Will hand sanitizer be refilled by department: Y <input checked="" type="checkbox"/> N <input type="checkbox"/> If No, describe:
50.	All Safety Data Sheets (SDS) and cleaning procedures used are found here .	<input checked="" type="checkbox"/>	<input type="checkbox"/>	<input type="checkbox"/>	If not, describe:
51.	The area(s) have been decluttered so that cleaning is simplified.	<input checked="" type="checkbox"/>	<input type="checkbox"/>	<input type="checkbox"/>	
52.	Barrier cleaning process has been arranged if the barrier(s) could become contaminated.	<input checked="" type="checkbox"/>	<input type="checkbox"/>	<input type="checkbox"/>	Barriers can become contaminate if they are a touch point or if the contaminated with droplets by e.g. coughing or sneezing.
53.	Common touch points and tools/equipment that must be shared are identified and cleaned between students and classes.	<input checked="" type="checkbox"/>	<input type="checkbox"/>	<input type="checkbox"/>	Cleaning/sanitizing procedures for common touch points and shared items are posted e.g. shared machinery, equipment, tools, etc. Identify who will clean and how often (e.g. staff and/or students): Students to clean work areas at end of class.



COVID-19 SAFETY PLAN ACADEMIC SPACES

#	Control Measure	Yes	No	NA	Details (as per Directions)
54.	Storage space for personal articles have been identified and are cleaned regularly.	<input type="checkbox"/>	<input type="checkbox"/>	<input checked="" type="checkbox"/>	<i>Who will clean:</i> Part-time students – no storage required. <i>Where is the storage:</i>
55.	Other:	<input type="checkbox"/>	<input type="checkbox"/>	<input checked="" type="checkbox"/>	
AUDIT AND CONTINUOUS IMPROVEMENT					
56.	There is a plan to conduct regular inspections of all control measures and safety protocols to ensure they are in place.	<input checked="" type="checkbox"/>	<input type="checkbox"/>	<input type="checkbox"/>	<i>Ensure this COVID-19 Safety Plan is posted. Who will conduct these inspections and how often?</i> Department head or designate will inspect weekly.
57.	Audits of inspections are planned to ensure that control measures continue to be effective.	<input checked="" type="checkbox"/>	<input type="checkbox"/>	<input type="checkbox"/>	<i>Who conduct the audits and how often?</i> Associate dean or designate on a monthly basis.

APPROVAL

All COVID-19 risk control measures for this campus activity are in place.			
Manager	Name Paul Morrison	Position Associate Dean	Date October 16, 2020
EOC	Name <i>Glen Magel</i>	Position EOC Director	Date October 20, 2020

REVISION APPROVAL *(if applicable)*

All COVID-19 risk control measures for this campus activity are in place.			
Manager	Name	Position	Date
EOC	Name	Position	Date

BCIT COVID-19 SAFETY PLAN ACADEMIC SPACES

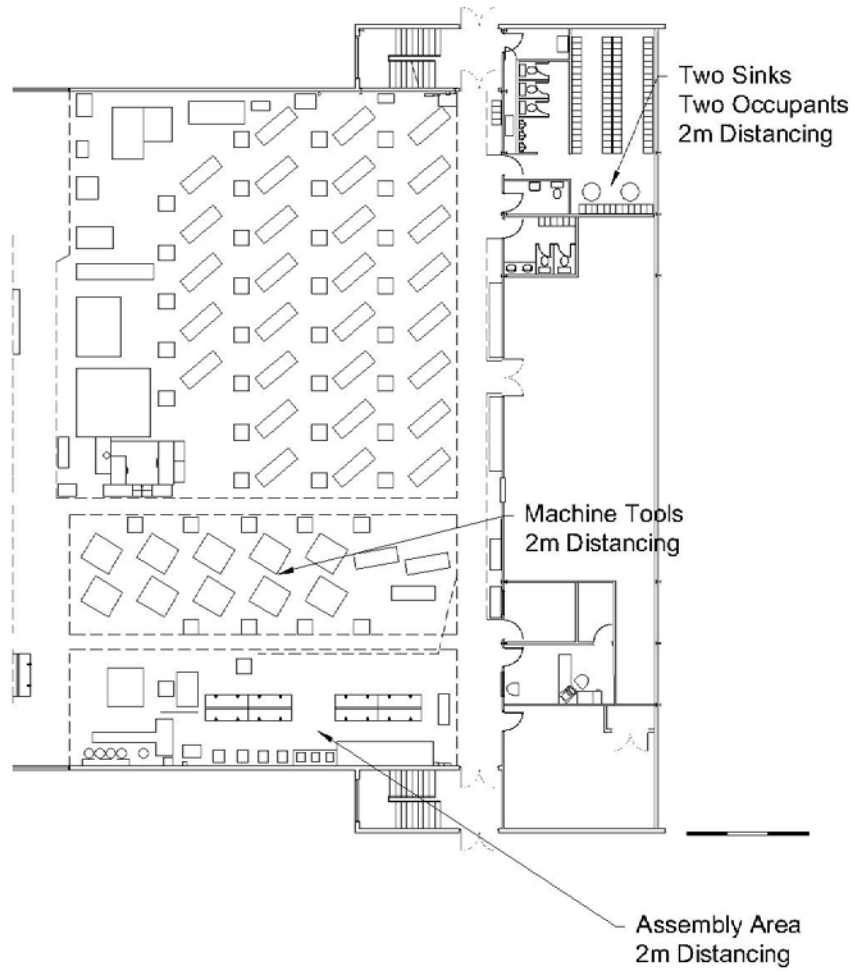

Building	Room	Typical Cap.	Physical Distance Cap.
NW06	100	52	30