



## Burnaby Campus

BCIT's Burnaby Campus is the largest of our five locations and offers a variety of rental options to suit your unique event needs.

Conveniently located beside the Trans Canada Highway, the Burnaby Campus has ample and affordable parking, hotel accommodations nearby and two major shopping centres within minutes. The campus is easily accessible by Skytrain (Metrotown or Brentwood stations) and bus (130). Some area hotels also offer free shuttle service to BCIT.

**Book your event today.**

**604.431.4997**

**meetings@bcit.ca**

**bcit.ca/rentals**

### Meeting Room Rental Rates

	Building and Room Names and Numbers	Square Footage	Seating Arrangement and Capacity							Price Per Day*	Price Per Half Day*
			Theatre	Classroom	U-Shape	Hollow Square	Boardroom	Reception	Banquet		
Conference Rooms	SE2 Town Square A 212A	1,480	80	45	35	40	35	135	64	\$335	\$250
	SE2 Town Square B 212B	1,370	80	40	35	40	35	135	64	\$310	\$230
	SE2 Town Square A&B 212	2,900	140	90				275	130	\$540	\$400
	SE2 Town Square C 213	600	45	30	20	28	25	55	32	\$180	\$135
	SE2 Town Square D 214	1,440	100	54	30	40	32	125	72	\$260	\$195
Lecture Theatres	Telus Theatre (SE6) 233		300							\$540	\$400
	NE1 331		130							\$300	\$225
	SW1 1021 or 1025		100							\$250	\$190
	SW1 1205		233							\$380	\$285
	SW3 1710 or 1750		100							\$250	\$190
	SW5 1840 or 1850		179							\$380	\$285
	SW5 1840/1850		358							\$540	\$400
Classrooms	Small Classroom			25						\$140–160	\$105–120
	Large Classroom			50+						\$190–250	\$145–190

\* All rates are subject to change. Please visit our website for the most current information.



Typical Lecture Theatre



Town Square A&B

## Town Square Conference Rooms

The heart of BCIT's Burnaby Campus, Building SE2, features four Town Square conference rooms that offer an array of sizes and set-up options to meet your requirements. The building is also conveniently located close to four dining facilities including Habitat pub, The Rix café featuring Starbucks, Tim Hortons and a food court-style cafeteria.

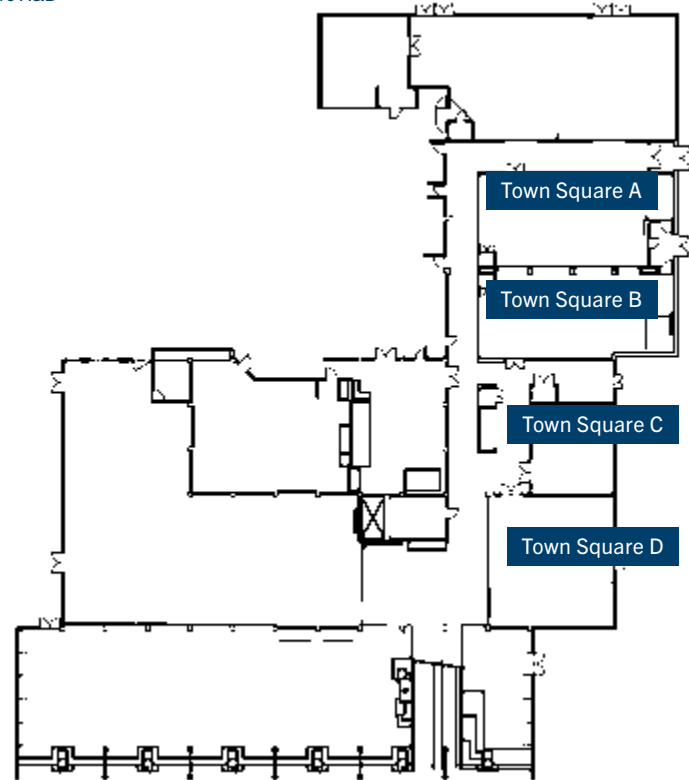

Building South East (SE2)

## Lecture Theatres and Classrooms

There are a wide variety of lecture theatre and classroom options available across the Burnaby Campus. All rooms are equipped with whiteboards and overhead projectors and capacities range from classrooms that seat 25 people to theatres that seat 350 people.

### Telus Theatre

The tiered seating in the Telus Theatre comfortably accommodates up to 300 people, with all the amenities required for your lecture-style event: sound system, lighting and a ceiling-mounted LCD projector. Ten adjoining classrooms are available for smaller meetings and breakout sessions. Perfect for a reception or sign-in area, the foyer outside the Telus Theatre is mere steps to the Town Square rooms and Great Hall.



Telus Theatre